

 **Gianni
Ferrari**

***PG
PG XPRO
SR XPRO***



EN





PG
PG XPRO
SR XPRO

Compact Multi-functional Efficient

 Gardening

 Cleaning

 Winter



WATCH THE VIDEOS

THE RANGE

The PG, PG XPRO and SR XPRO stand out as extremely versatile lawn mower tractors thanks to their possibility of being equipped with different types of attachments. **Ideal for both public and private lawn care**, they can be equipped with different types of sweepers, vacuum hoses, snow blades and salt spreaders for cleaning outdoor areas even in the autumn and winter seasons.

The PG range has a **2-wheel drive petrol** model with a Briggs & Stratton two-cylinder motor, available with two collector basket configurations of 600 and 800 litres. The **diesel** alternative, also with **2-wheel drive**, is fitted with a 22HP Kubota three-cylinder motor and has only an 800 litre collector available.

PG 220 D



PG 230



Collector capacity: 600-800 lt



Drive wheels: 2WD



Speed: 11 km/h



Power: 22-23 HP

For even greater performance, the PG 280 model offers a 26 HP Kubota motor in **2- and 4-wheel drive** variants. The 4-wheel drive version is suitable for use on both flat and undulating terrain thanks to the **HTC system** (Hydrostatic Traction Control), which guarantees perfect traction even on the steepest slopes.

PG collection lawn mower tractors offer excellent cutting performance even with tall, wet grass, thanks to the collection system with **built-in turbine**.

PG 280 DW



PG 280 D

On the XPRO version, driving and working **comfort** have been further developed: the driver's seat features a silent-block mounted platform and the control panel has been completely redesigned, providing the operator with more intuitive **accessibility** and **use of the instruments**.

This version also features as standard a **system for disengaging the suction turbine** independently of the PTO.



PG 280 D XPRO
PG 280 DW XPRO



Collector capacity: 800 lt



Drive wheels: 2WD - 4WD



Speed: 13-15 km/h



Power: 26 HP

As a variant of the PG XPRO model, the SR XPRO offers **cutting without collecting**. Without turbine, elevator or collector; can be equipped with mulching deck or MFA Smart System flail mower.

Available upon request with a hydraulically tilting tipper.

SR 280 DW XPRO



Drive wheels: 4WD



Speed: 15 km/h



Power: 26 HP

CUTTING SYSTEM

Collecting mower decks in the PG range are equipped with discs with **dual pairs of anti-collision retractable blades**. **Floating**, so as to adapt naturally to the undulations of the ground for a continuously accurate cut, with **puncture-proof**, solid rubber **wheels**.

Blade transmission by means of mechanical reducers and **helical bevel gears in an oil bath**, is robust and reliable.

The exclusive cutting height adjustment of the 126 SA and 130 RCA decks is carried out by **turning a single lever**, very quickly and effortlessly.



130 RCA mowers are distinguished by the direction of rotation of the blades, which is opposite to that of traditional mowers. The reverse rotation combined with the unique shape of the desk shell offer **excellent cutting quality** and a **high collection capacity** even with tall, wet grass.

The **front opening of the deck**, equipped with mobile safety flaps, prevents the grass from over-bending for a more accurate cut.



3 GREAT ADVANTAGES



The **swing back blades** absorb shocks and protect the transmission against impact with foreign objects left in the grass.



The cut material is reduced to **very small particles**, improving collection and compacting in the collector.



The **dual blades** prevent the accumulation of grass and soil debris in the top inside part of the mower deck, maintaining cut quality uniform throughout the session, and reducing downtime for cleaning the deck.



COLLECTION SYSTEM

The PG range loading system features an integrated collection system: **the suction turbine and the collection hose** are housed **inside the traction unit**.

There are many advantages to this solution:

- No bulky external collection hoses, **keeping the machine dimensions small**. The mower is easy to manoeuvre and can be used in tight spaces and thus increase productivity.
- **Increased stability and compactness thanks to smaller lateral dimensions**.
- **More effective collection**.

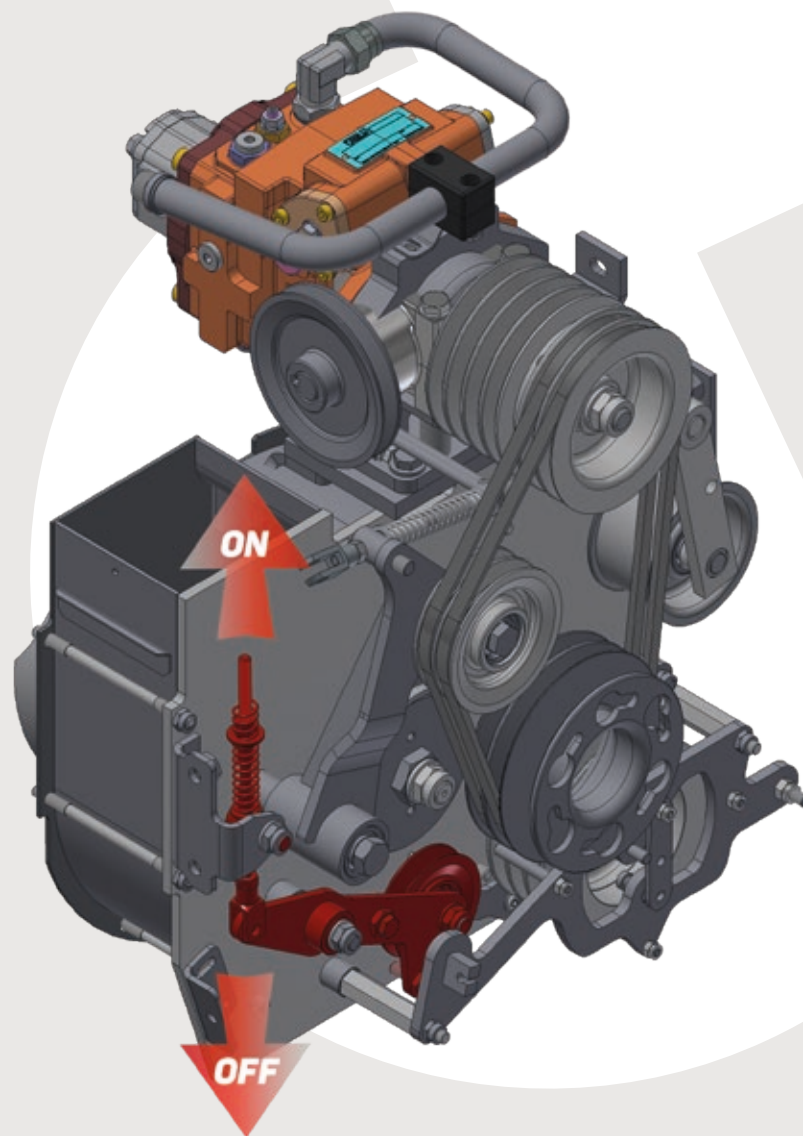

The XPRO version features as standard a **system for disengaging the suction turbine** independently of the PTO.

COLLECTOR

The large collector is equipped with a **filtering screen** and a warning buzzer to indicate when the grass catcher is full. The filter is easily removable for cleaning. The buzzer advises the operator to disengage the PTO when

the collector is full, to prevent clogging the collecting duct.

The **motorised swivel spreader** compacts grass and fills the hopper evenly by making the most of its capacity.

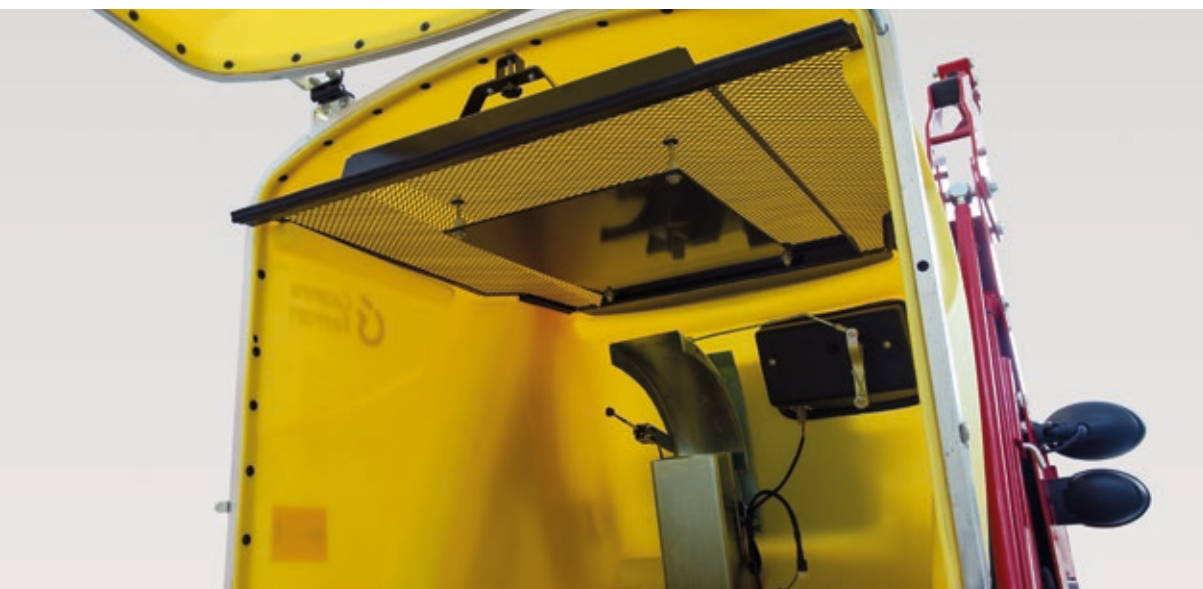

An efficient high-lift dump allows the operator to **easily and rapidly discharge the cut grass** directly into a truck or a trailer.

The collector can optionally be equipped with a **dust filter** to minimise the exit of dust and collected material. Self-cleaning with electric motor for each disengaging of the suction turbine.





DRIVER'S POSITION

Special attention has been paid to the **ergonomics** of the driver's position to increase the **safety** and **comfort** of the operator during long working days.

The **steering wheel** is mounted on a **movable structure that can be adjusted vertically** to ensure a correct driving position at all times.

The seat allows each operator to find the most **comfortable** driving position.

Heated version and **version with pneumatic suspension** available upon request.

In the basic version, the PG model retains the parking brake and disconnect switch on the right of the driver's position, while the PTO, accelerator and hydraulic controls are on the left.



On the XPRO version, the main controls have been positioned to the right of the operator for **greater convenience** and **ease of use**. An **LCD**

dashboard is available for the entire range for optimal machine management during use.

TRANSMISSION

All models in the range have a **gear-driven axle** with **oil bath differential** and **differential lock**, which is coupled to a hydraulic piston motor.

A simple steering axle is located at the rear for the 2WD versions, while in the 4WD versions two hydraulic motors provide **4-wheel drive** and the **HTC control system** ensures optimum grip even when turning and no crawling.

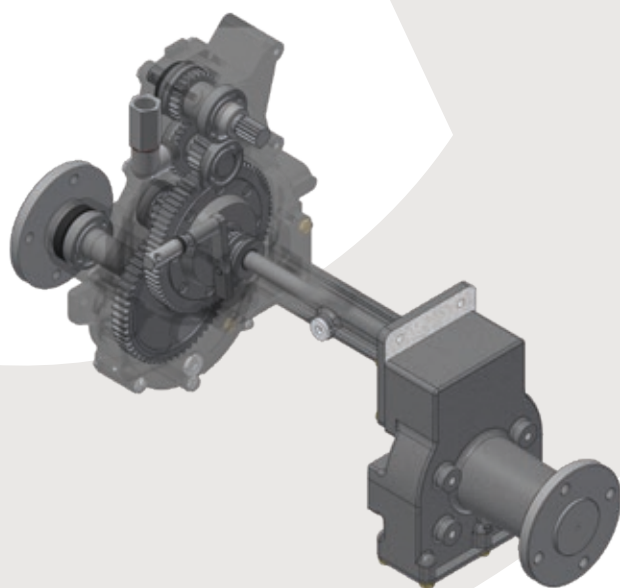





SAFETY

All the machines in the range are equipped with **ROPS**, a protective device in case of a machine roll over, to which a **canopy** can be

fitted **upon request**, which is useful as sun and rain protection and also protects the driver from branches when working under trees.





Attachments

1 Collection deck 112 / 126 SA / 130 RCA

Collection deck	112	126 SA	130 RCA
Features	2 Discs with double pairs of retractable anti-collision blades		
Working width	110 cm	126 cm	130 cm
Overall dimensions (Length/Width/Height)	240/112/39 cm	288/126/12 cm	303/133/13 cm
Cutting height adjustable via lever	From 1,5 to 9 cm	From 2 to 8 cm	From 2 to 8 cm
Weight	90 kg	106 kg	145 kg
Optional	-	Hydraulic cutting height adjustment kit	
	Kit mulching	Kit mulching	Standard mulching stopper



2 Mulching deck/rear discharge 130 Inline™

This type of deck offers the possibility to change from one type of cutting to another with ease.

130 Inline™ deck	
Features	3 discs with retractable blades
Working width	130 cm
Overall dimensions (Length/Width/Height)	130/135/30 cm
Cutting height adjustable via lever	From 0,5 to 8 cm
Weight	120 kg



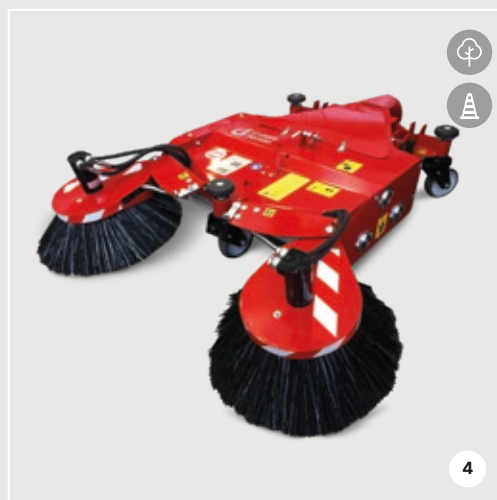
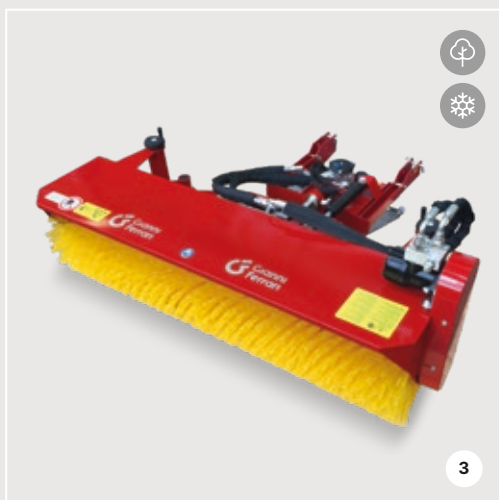
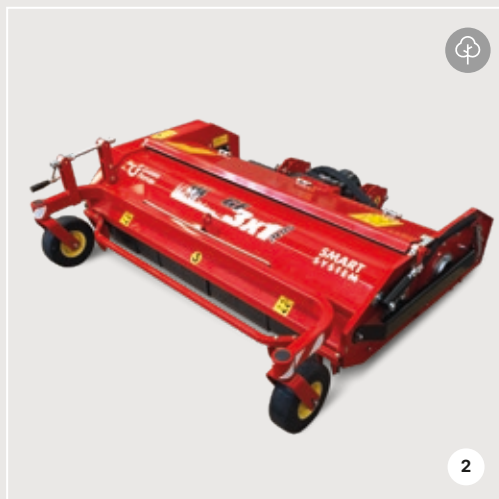

1 Flail mower MFA Smart System 110 MFA/135 MFA

Flail mower suitable both for cutting fine grass (paddle blades) and for clearing rustic areas with undergrowth (Y-blades). These vertical blades combined with the previous ones aerate the soil during work. Three types of work with one piece of equipment. Thanks to the Smart System blade changing system with magnets, blades can be changed quickly directly in the field.

Flail mower with aeration (48/56 Y-blades)

Working width	110 cm	135 cm
Standard supply	Spoon blade kit and vertical blade kit (24 blades)	Spoon blade kit and vertical blade kit (28 blades)
Overall dimensions (Length/Width/Height)	113/157/53 cm	135/157/50 cm
Cutting height adjustable via lever	From 0,5 to 8 cm	From 0,5 to 8 cm
Weight	120 kg	188 kg

2 Collection flail mower 3×1 Plus Smart System 140

Equipment that offers three different types of use depending on work requirements: cutting with collection, cutting without collection and aeration. Suitable both for cutting fine grass on elegant lawns and for clearing land with undergrowth and very tall grass.

Flail mower with collection and aeration (56 Y-blades)

Working width	135 cm
Standard supply	Spoon blade kit and vertical blade kit (28 blades)
Overall dimensions (Length/Width/Height)	130/157/50 cm
Cutting height adjustable via lever	From 0,5 to 8 cm
Weight	280 kg

3 Rotary sweeper

Rotary sweeper with hydraulic orientation

Features	Plastic sweeper brush Ø45 cm
Working width	140 cm
Overall dimensions (Length/Width/Height)	151/130/70 cm
Weight	115 kg

4 Two-stage collection sweeper SMG 120

Equipped with hydraulic transmission and double brush.

SMG 120

Working width	120 cm
Brush diameter	Ø47 cm
Optional	Anti-dust filter and water spray kit
Overall dimensions (Length/Width/Height)	151/130/70 cm
Weight	100 kg

1 Rotary sweeper for unfilled artificial turfs/rotary sweeper for artificial turfs with rubber and sand infill

	WITHOUT INFILL	WITH RUBBER AND SAND INFILL
Working width	100 cm	100 cm
Roller diameter	50 cm	50 cm
Overall dimensions (Length/Width/Height)	150/123/31 cm	155/105/52 cm
Weight	98 kg	124 kg

2 Vacuum

Used in all seasons to vacuum up dry leaves, pine needles and ensure easy cleaning of public and private areas, pavements and car parks.

Polycarbonate hose

Length	500 cm
Diameter	16 cm
Weight	10,5 kg

3 Snow blade

Hydraulic orientation

Working width	130 cm	150 cm
Hydraulic adjustment	30° left - 30° right	35° left - 35° right
Overall dimensions (Length/Width/Height)	125/130/48 cm	131/150/57 cm
Weight	75 kg	114 kg

4 Salt spreader

Polaro Salt spreader	110
Capacity	110 lt
Spreading width	From 80 to 600 cm
Overall dimensions (Length/Width/Height)	60/50/108 cm
Weight	40 kg

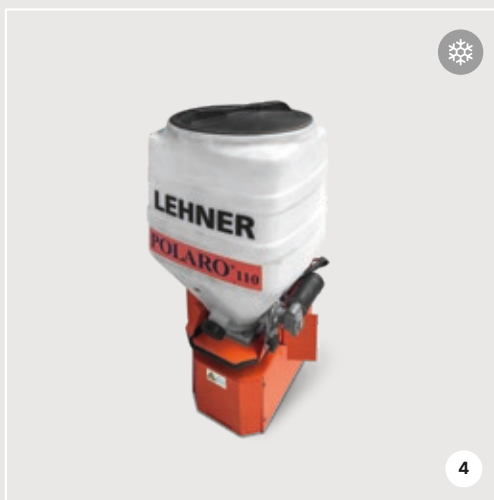
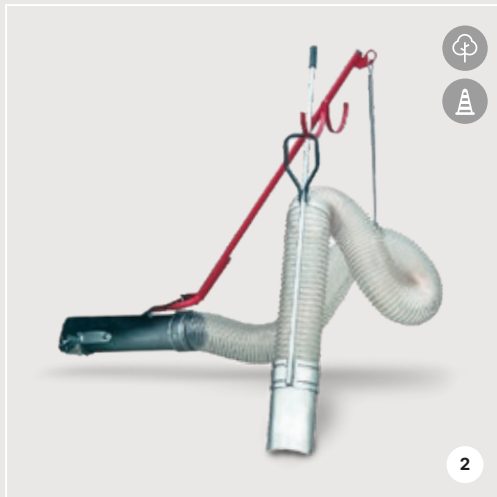

Technical features

Model	PG 280D XPRO	PG 280DW XPRO	SR 280DW XPRO
Motor			
Manufacturer	Kubota	Kubota	Kubota
Model	D1105- E4	D1105- E4	D1105- E4
Fuel	Diesel	Diesel	Diesel
Emissions	Stage V	Stage V	Stage V
Cylinders	3	3	3
Power	19,2 kW	19,2 kW	19,2 kW
Cylinder capacity	1123 cc	1123 cc	1123 cc
Power	26 HP	26 HP	26 HP
Cooling	Liquid	Liquid	Liquid
Fuel tank capacity	30 liters	30 liters	30 liters
Transmission			
Transmission type	Hydrostatic transmission	Hydrostatic transmission	Hydrostatic transmission
Forward speed	13 km/h	15 km/h	15 km/h
Forward / Reverse motion	Double pedal operation	Double pedal operation	Double pedal operation
Traction control	/	HTC system	HTC system
Mechanical differential lock	•	•	•
Driving wheels	2WD	4WD	4WD
Wheel transmission	Compact motor/pump unit on front axle with gearbox	Variable displacement axial piston pump. Piston motor on front axle with gearbox. Orbital motors on rear wheels.	Variable displacement axial piston pump. Piston motor on front axle with gearbox. Orbital motors on rear wheels.
Power take-off	Mechanical with Cardan shaft, push-button engagement	Mechanical with Cardan shaft, push-button engagement	Mechanical with Cardan shaft, push-button engagement
Auxiliary circuit	Standard auxiliary hydraulic couplings	Standard auxiliary hydraulic couplings	Standard auxiliary hydraulic couplings
Brakes	Hydrostatic service brake. Disc parking brake on front axle	Hydrostatic service brake. Disc parking brake on front axle	Hydrostatic service brake. Disc parking brake on front axle
Steering system	Power steering wheel, reduced-radius steering on rear wheels	Power steering wheel, reduced-radius steering on rear wheels	Power steering wheel, reduced-radius steering on rear wheels
Collection system			
Type of collection	With built-in turbine-assisted	With built-in turbine-assisted	
Collector	In polyethylene. Removable filtering screen for cleaning. Buzzer warning of full load. Powered spreader.	In polyethylene. Removable filtering screen for cleaning. Buzzer warning of full load. Powered spreader.	
Collector capacity	800 liters	800 liters	
Elevator	Hydraulic	Hydraulic	
Maximum emptying height	205 cm	205 cm	
Dimensions and weight			
Front wheels	23×10.50-12	23×10.50-12	23×10.50-12
Rear wheels	16×7.50-8	16×7.50-8	16×7.50-8
Length/ Width/ Height with ROPS	233×112×205 cm	233×112×205 cm	233×112×205 cm
Length/ Width/ Height without ROPS	233×112×170 cm	233×112×170 cm	233×112×170 cm
Weight (without equipment)	965 kg	1065 kg	950 kg

Model	PG 230	PG 220 D	PG 280 D	PG 280 DW
Motor				
Manufacturer	Briggs & Stratton	Kubota	Kubota	Kubota
Model	V- Twin 386400	D902	D1105- E4	D1105- E4
Fuel	Benzina	Diesel	Diesel	Diesel
Emissions	Stage V	Stage V	Stage V	Stage V
Cylinders	2	3	3	3
Power	16,9 kW	16,2 kW	19,2 kW	19,2 kW
Cylinder capacity	627 cc	898 cc	1123 cc	1123 cc
Power	23 HP	22 HP	26 HP	26 HP
Cooling	Air	Liquid	Liquid	Liquid
Fuel tank capacity	30 liters	30 liters	30 liters	30 liters

Transmission

Transmission type	Hydrostatic transmission	Hydrostatic transmission	Hydrostatic transmission	Hydrostatic transmission
Forward speed	11 km/h	11 km/h	11 km/h	15 km/h
Forward / Reverse motion	Single pedal operation	Single pedal operation	Single pedal operation	Single pedal operation
Traction control	/	/	/	HTC system
Mechanical differential lock	•	•	•	•
Driving wheels	2WD	2WD	2WD	4WD
Wheel transmission	Compact motor/pump unit on front axle with gearbox	Compact motor/pump unit on front axle with gearbox	Compact motor/pump unit on front axle with gearbox	Variable displacement axial piston pump. Piston motor on front axle with gearbox. Orbital motors on rear wheels.
Power take-off	Mechanical, with manual lever for engagement	Mechanical, with manual lever for engagement	Mechanical, with manual lever for engagement	Mechanical, with manual lever for engagement
Auxiliary circuit	Optional auxiliary hydraulic couplings	Optional auxiliary hydraulic couplings	Optional auxiliary hydraulic couplings	Optional auxiliary hydraulic couplings
Brakes	Hydrostatic service brake. Disc parking brake on front axle	Hydrostatic service brake. Disc parking brake on front axle	Hydrostatic service brake. Disc parking brake on front axle	Hydrostatic service brake. Disc parking brake on front axle
Steering system	Power steering wheel, reduced-radius steering on rear wheels	Power steering wheel, reduced-radius steering on rear wheels	Power steering wheel, reduced-radius steering on rear wheels	Power steering wheel, reduced-radius steering on rear wheels

Collection system

Type of collection	With built-in turbine	With built-in turbine	With built-in turbine	With built-in turbine
Collector	In polyethylene. Removable filtering screen for cleaning. Buzzer warning of full load.	In polyethylene. Removable filtering screen for cleaning. Buzzer warning of full load.	In polyethylene. Removable filtering screen for cleaning. Buzzer warning of full load. Powered spreader.	In polyethylene. Removable filtering screen for cleaning. Buzzer warning of full load. Powered spreader.
Collector capacity	600/800 liters	600 liters	800 liters	800 liters
Elevator	Hydraulic	Hydraulic	Hydraulic	Hydraulic
Maximum emptying height	190 cm	190 cm	192 cm	196 cm

Dimensions and weight

Front wheels	20×10.00-8	20×10.00-8	23×10.50-12	23×10.50-12
Rear wheels	15×6.00-6	15×6.00-6	16×7.50-8	16×7.50-8
Length/ Width/ Height with ROPS	225×106×199 cm	225×106×199 cm	227×114×201 cm	227×114×205 cm
Length/ Width/ Height without ROPS	225×106×164 cm	225×106×164 cm	227×114×166 cm	227×114×170 cm
Weight (without equipment)	700 kg	820 kg	840 kg	940 kg



gianniferrari.com

